

THIS DRAWING IS PROVIDED AS A REFERENCE TO THE PROFESSIONAL GUNSMITH. IT IS IMPOSSIBLE FOR ACCURATE - MAG PRODUCTS TO PROVIDE A DEFINITIVE INLETING DESIGN DUE TO VARIABLES FOUND IN INDIVIDUAL RIFLES AND RIFLE STOCKS, MACHINE TOOLS, CUTTERS, MACHINING METHODS, MACHINIST'S SKILLS AND END USER EXPECTATIONS.

REVISIONS				
ZONE	REV.	DESCRIPTION	DATE	APPROVED
	A	NEW DRAWING	9-23-10	GPD

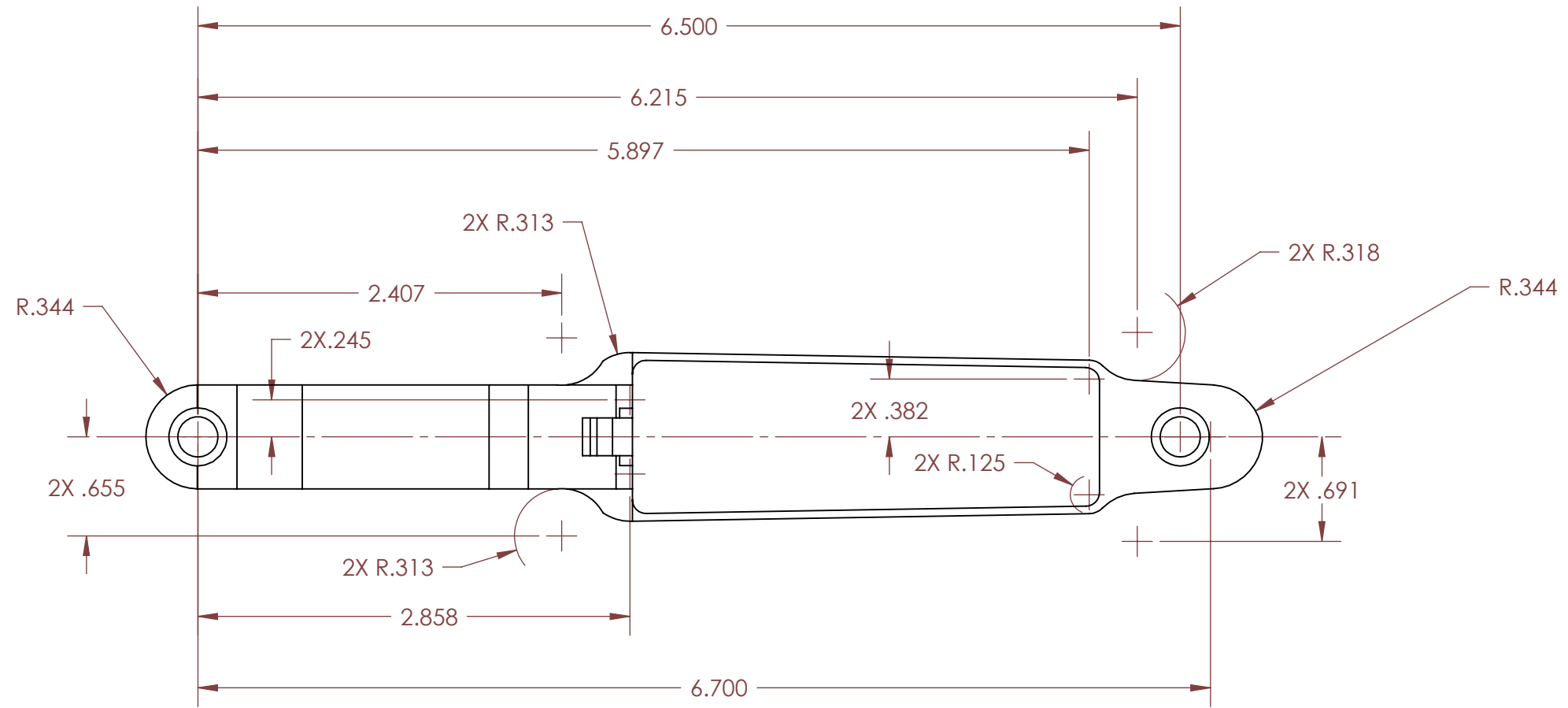

NOTES:

1. DIMENSIONS ARE TO NOMINAL BOTTOM METAL. RECOMMENDED INETTING IS +.010 ALL AROUND.
2. DETERMINE DEPTH OF CUTS BY TAKING DIMENSIONS FROM THE ACTUAL PART BEING INLET.

APPLICATION	
00200-0005	SHORT ACTION 3.050 TRIG GRD ASSY

UNLESS OTHERWISE SPECIFIED:		NAME	DATE	B.M.L. Tool & Mfg. Corp.
DIMENSIONS ARE IN INCHES		DRAWN BY	GPD 9-23-10	
TOLERANCES:		CHECKED		
FRACTIONAL ±1/32		ENG APPR.		
ANGULAR: MACH ± .5° BEND ± 5°		MFG APPR.		TITLE: INLETING; SHORT ACTION
DRAFT: ± .25°		Q.A.		
TWO PLACE DECIMAL ±.02		COMMENTS:		SIZE
THREE PLACE DECIMAL ±.005		DO NOT SCALE DRAWING		DWG. NO.
INTERPRET GEOMETRIC TOL. PER: ASME Y14.5M-1994				REV
MATERIAL				B STD-0101 A
FINISH				SCALE: 1:1
FILE: STD-101revA				WEIGHT:
				SHEET 1 OF 1

PROPRIETARY AND CONFIDENTIAL
 THE INFORMATION CONTAINED IN THIS DRAWING IS THE SOLE PROPERTY OF BML Tool & Mfg. Corp. D.B.A. Accurate-Mag. ANY REPRODUCTION IN PART OR AS A WHOLE WITHOUT THE WRITTEN PERMISSION OF BML Tool & Mfg. Corp. D.B.A. Accurate-Mag. IS PROHIBITED.