

THIS DRAWING IS PROVIDED AS A REFERENCE TO THE PROFESSIONAL GUNSMITH. IT IS IMPOSSIBLE FOR ACCURATE-MAG PRODUCTS TO PROVIDE A DEFINITIVE INLETTING DESIGN DUE TO VARIABLES FOUND IN INDIVIDUAL RIFLES AND RIFLE STOCKS, MACHINE TOOLS, CUTTERS, MACHINING METHODS, MACHINISTS SKILLS AND END USER EXPECTATIONS. ALL DIMENSIONS FOR REFERENCE PURPOSES.

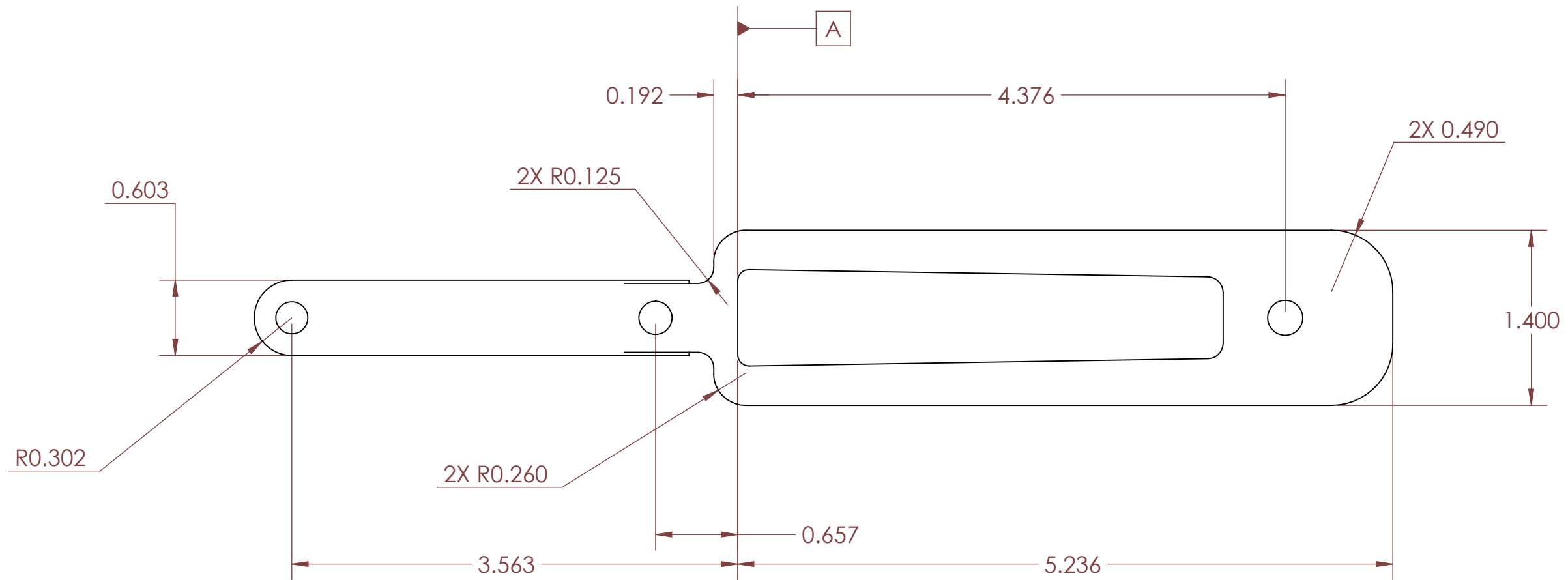

NOTES:

1. DIMENSIONS ARE TO NOMINAL BOTTOM METAL.
2. RECOMMENDED INLETTING IS  $\pm .010$  ALL AROUND.
3. DETERMINE DEPTH OF CUTS BY TAKING DIMENSIONS FROM ACTUAL PART BEING INLET.

**PROPRIETARY AND CONFIDENTIAL**  
 THE INFORMATION CONTAINED IN THIS DRAWING IS THE SOLE PROPERTY OF ACCURATE - MAG PRODUCTS. ANY REPRODUCTION IN PART OR AS A WHOLE WITHOUT THE WRITTEN PERMISSION OF ACCURATE - MAG PRODUCTS IS PROHIBITED.

		UNLESS OTHERWISE SPECIFIED:		NAME	DATE	ACCURATE - MAG PRODUCTS	
		DIMENSIONS ARE IN INCHES		DRAWN BY	GPD	4-15-2015	
		TOLERANCES:		CHECKED		TITLE:	
		FRACTIONAL $\pm 1/32$		ENG APPR.		INLETTING;	
		ANGULAR: MACH $\pm .5^\circ$ BEND $\pm 5^\circ$		MFG APPR.		SAVAGE LONG ACTION	
		DRAFT: $\pm .25^\circ$		Q.A.		SIZE	DWG. NO.
		TWO PLACE DECIMAL $\pm .02$		COMMENTS:		<b>B</b>	CD-150415
		THREE PLACE DECIMAL $\pm .005$				SCALE: 1:4	WEIGHT:
		INTERPRET GEOMETRIC TOL. PER: ASME Y14.5M-1994				SHEET 1 OF 1	
		MATERIAL					
		FINISH					
NEXT ASSY	USED ON						
APPLICATION		DO NOT SCALE DRAWING					

REV **A**